



FLOW MEASUREMENT DEVICE - STAINLESS STEEL



This article was made in compliance with the quality management requirements of standard ISO 9001:2008. All articles are tested according to the standard EN 12266-1:2003. It can be used in a wide variety of sectors: heating, air conditioning, water, sanitary systems and generally with any non corrosive liquid.

It is guaranteed for 5 years.

It is made of AISI 304 stainless steel.

Nominal Pressure: PN16

Operating temperature: $-10 \div 120^{\circ}\text{C}$

FLOW AND PRESSURE DROP

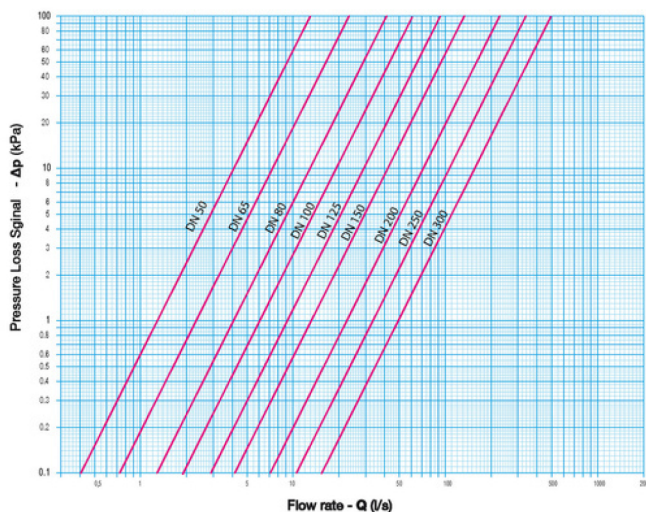

Notes:
 1 l/s = 3.6 m³/h
 1 m³/h = 0.278 l/s
 1 kPa = approx. 100 mm
 1 bar = 100 kPa

PRESSURE TEMPERATURE RATINGS

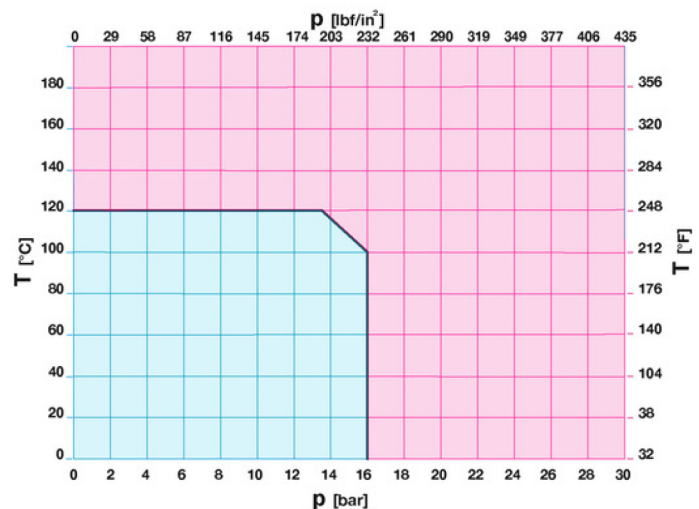

Notes:
 1 bar = 14,5 psi
 1 bar = 14,5 lb_f/in²
 $^{\circ}\text{C} = 5/9 \times (^{\circ}\text{F} - 32)$
 $^{\circ}\text{F} = 32 + (9/5 \times ^{\circ}\text{C})$

TECHNICAL DRAWING

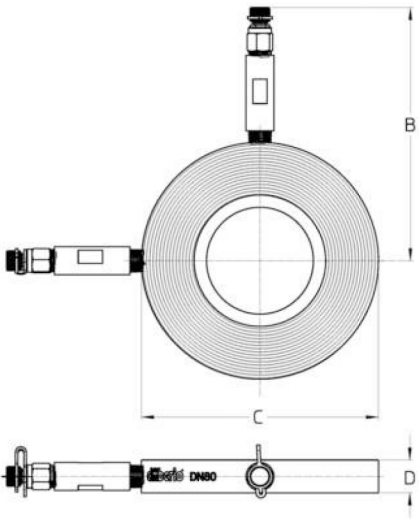

DN	50	65	80	100	125	150	200	250	300
Grms.	1300	1800	1890	2120	2640	3190	4440	5780	8000
B	136	145	154	164	179	192	219	248	274
C	108	125	144	164	194	220	275	333	385
D	20	20	20	20	20	20	20	20	20

TECHNICAL CHARACTERISTICS

KVS									
DN	50	65	80	100	125	150	200	250	300
KVS	47,5	88,5	150,6	281,1	328,8	477,5	826	1218	1794

KVS = Flow rate in m³/h at a pressure drop of 1 bar