

## FLANGED BRONZE LIFT CHECK VALVE WITH P.T.F.E. DISC - PN 10



This article was made in compliance with the quality management requirements of standard ISO 9001:2008. All articles are tested according to the standard EN 12266-1:2003. It is used in a wide variety of sectors for non-return piping systems: heating, air-conditioning, drinking water, sanitary and hydrocarbon distribution systems.

It is guaranteed for 5 years.

It is made of a bronze alloy that complies with standard EN 1982-CC491K.

Nominal Pressure: PN16

Operating temperature:  $-10 \div 170^{\circ}\text{C}$

### FLOW AND PRESSURE DROP

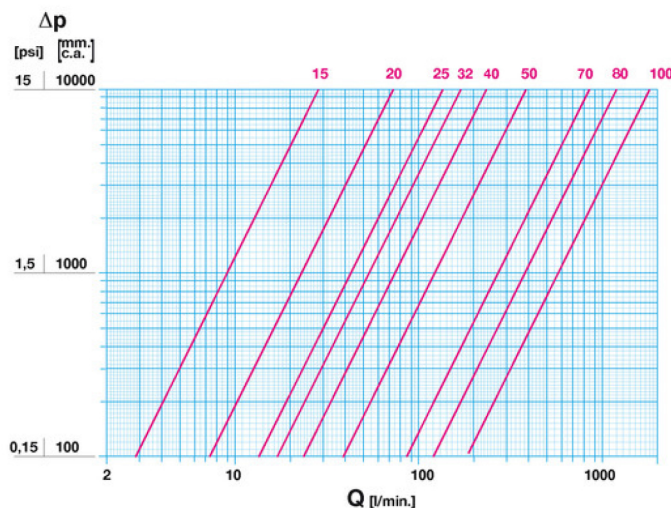

Notes:

1 l/min = 0,06 m<sup>3</sup>/h  
 1 m<sup>3</sup>/h = 16,67 l/min  
 1 bar = 10.000 mm w.c.  
 1 psi = 690 mm w.c.

### PRESSURE TEMPERATURE RATINGS

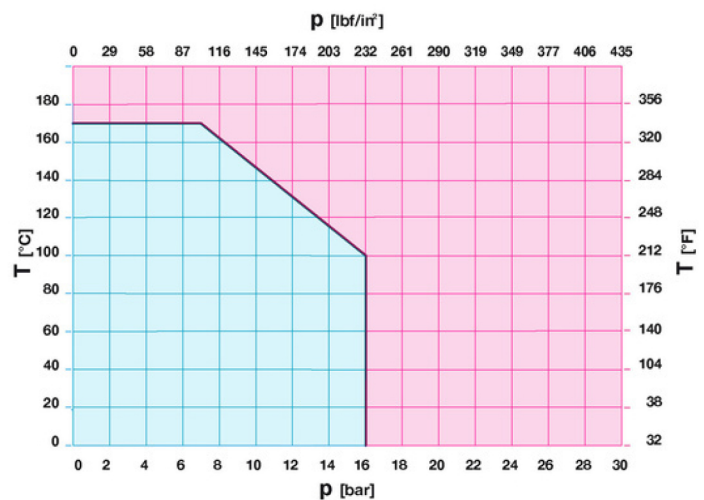

Notes:

1 bar = 14,5 psi  
 1 bar = 14,5 lbf/in<sup>2</sup>  
 $^{\circ}\text{C} = 5/9 \times (^{\circ}\text{F} - 32)$   
 $^{\circ}\text{F} = 32 + (9/5 \times ^{\circ}\text{C})$

TECHNICAL DRAWING

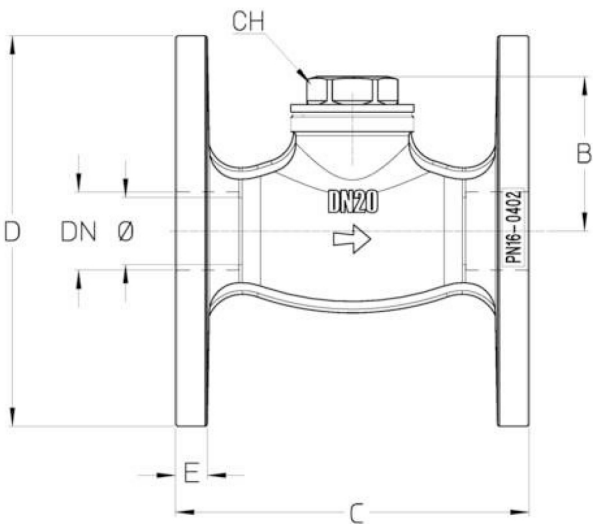

DN	1/2"	3/4"	1"	1"1/4	1"1/2	2"	2"1/2	3"	4"
Ø mm	16	21	26	33	40	52	72	82,5	101
Grms.	1225	1655	2340	3450	4445	5765	8075	10300	16185
B	35	41,5	46,5	53	60,5	69,5	73,5	90	110
C	82,5	95	104	113	133,5	153,6	170	179,5	200
D	94	105	119	138,5	147	163	185	199	230
E	8	8,5	9,5	9,5	11	11	13	13	17
CH	19	22	28	37	40	48	65	75	85

Flanging upon request:

UNI EN 1092  
BS 10 tables D - E - F  
ASA 150  
ANSI B16.5

TECHNICAL CHARACTERISTICS

KV									
DN	1/2"	3/4"	1"	1"1/4	1"1/2	2"	2"1/2	3"	4"
Ø mm	15	20	25	32	40	50	70	80	100
KV	1,7	4,4	8	10	14	23	51	72	108

KV = Flow rate in m³/h with a pressure drop of 1 bar

OUR CERTIFICATIONS

